



**LOCKERS**  
*Personal Storage Range*





**LOCKERS**  
*Free Standing*



**FREE STANDING SINGLE & DOUBLE**

*Pictured in Jarrah Legno, Classic Oak*

*SINGLE 2 DOOR*

**H: 1800**

**W: 300**

**D: 500**

*DOUBLE 8 DOOR*

**H: 1800**

**W: 600**

**D: 500**

Simple, freestanding & flexible

Expand anytime

*Supplied as standard with Hafele Symo 3000*

*Master Keyed Lock Handle*

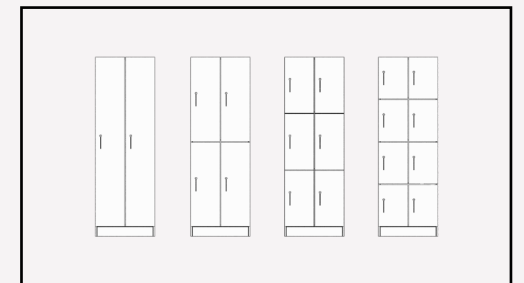
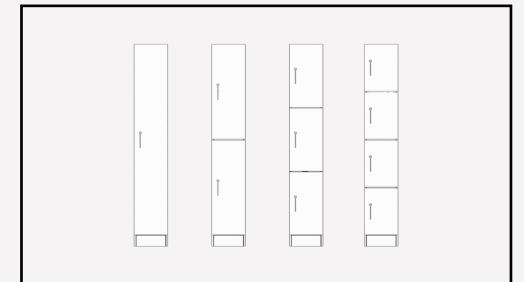

### 1 DOOR MODULE UNIT

*Pictured in Pillarbox, Black*

Also available in 2, 3 & 4 door versions

#### OVERALL DIMENSIONS

**H:** 1900

**W:** 2036

**D:** 500

#### MODULE DIMENSIONS

**H:** 1800

**W:** 400

**D:** 500

Highly customisable & expandable  
Division options for diverse uses  
*Supplied as standard with Hafele Symo 3000  
Master Keyed Lock Handle*

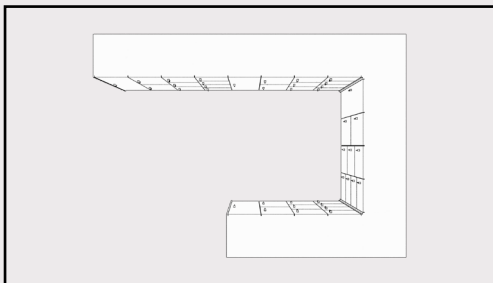
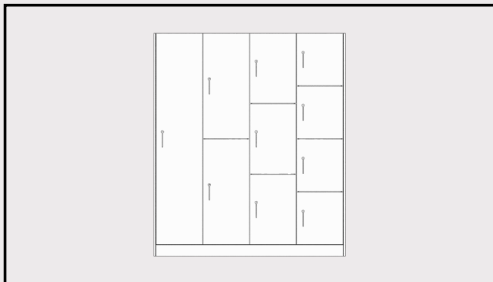



**EXPLODED VIEW**

*Pictured in Natural Walnut, Black*

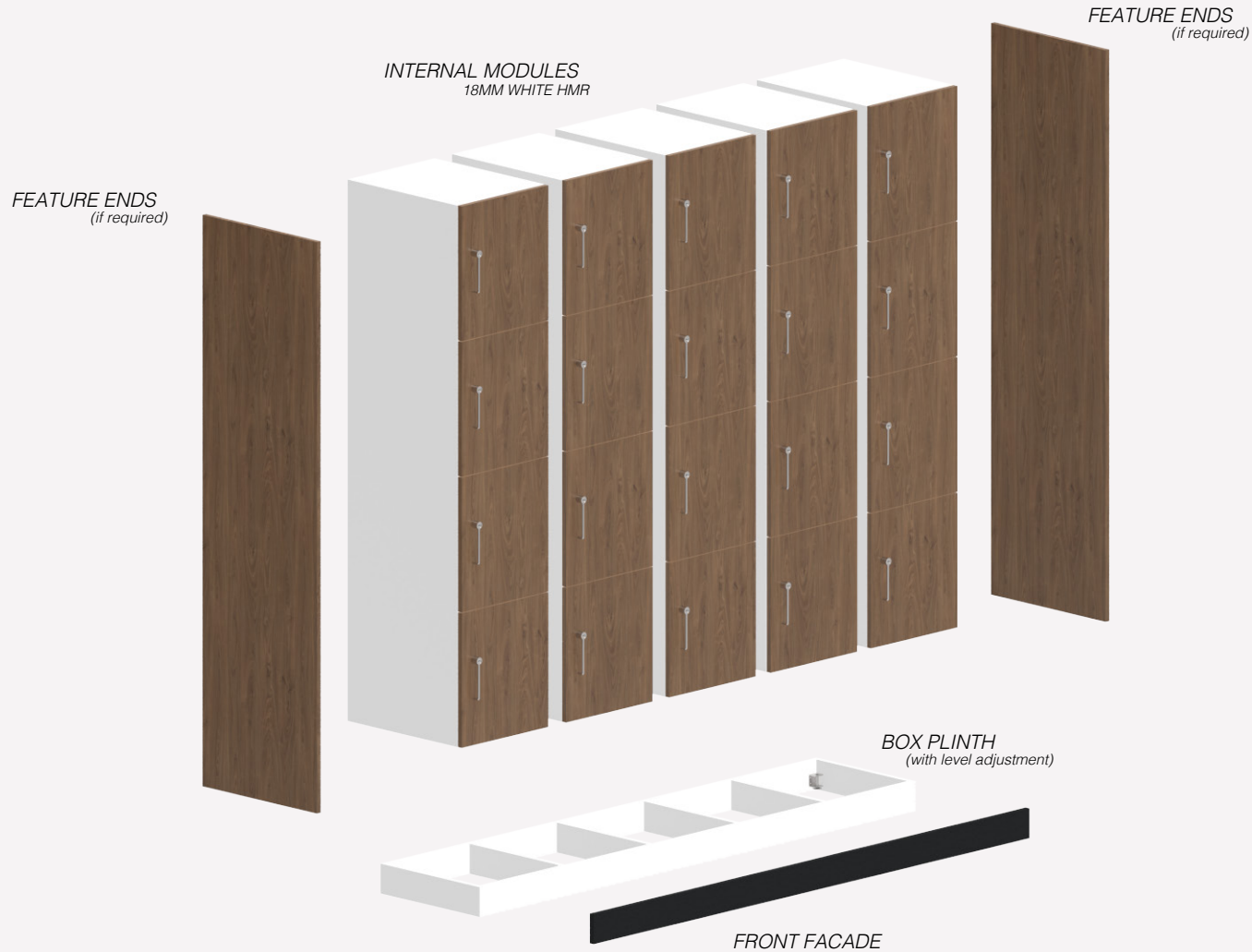

*EXPANDABLE DESIGN*

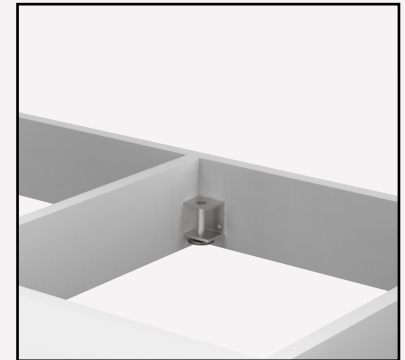

*ADJUSTABLE FEET*

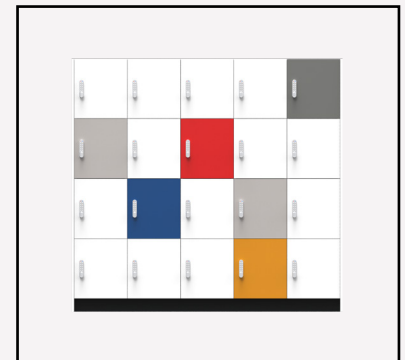

*HIGHLY CUSTOMISABLE*



# LOCKERS

Split Door Modular System

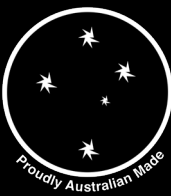

**SPLIT DOOR MODULE UNIT**  
*Pictured in Pillarbox, Olympia Blue,  
Olympia Yellow & Black, Classic Oak*

**OVERALL DIMENSIONS**

**H:** 1900  
**W:** 1236  
**D:** 500

**MODULE DIMENSIONS**

**H:** 1800  
**W:** 400  
**D:** 500

Highly customisable & expandable  
Includes hanging rail & shelf  
*Supplied as standard with Hafele Symo 3000  
Master Keyed Lock Handle*

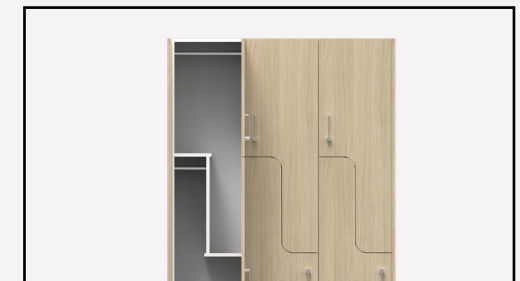
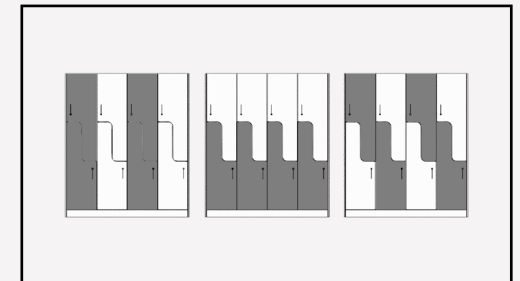



**MEETING & COLLABORATIVE BENCH  
WITH LOCKABLE STORAGE 4 X 2**

*Pictured in Classic Oak, Black  
with Cam Lock (Upgrade)*

*OVERALL DIMENSIONS*

**L: 1736**

**W: 1106**

**H: 1025**

*MODULE DIMENSIONS*

**H: 450**

**W: 400**

**D: 500**

Multipurpose, space saving unit  
*Supplied as standard with Hafele Symo 3000  
Master Keyed Lock Handle*

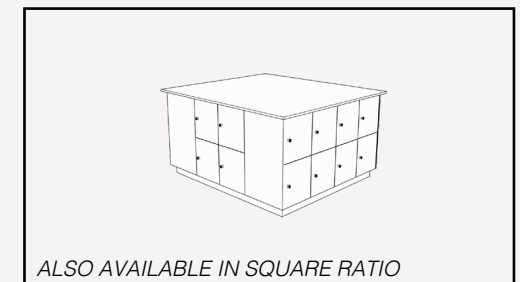
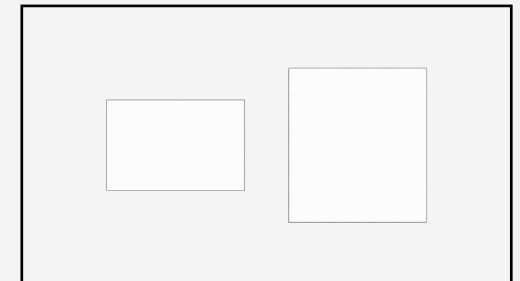

*ALSO AVAILABLE IN SQUARE RATIO*



# LOCKERS

*Options & Add-Ons*

PRODUCT	SHELF	HANGING RAIL
FREE STANDING SINGLE 1 DOOR	✓	✓
FREE STANDING SINGLE 2 DOOR	✓	✓
FREE STANDING SINGLE 3 DOOR	OPTION	X
FREE STANDING SINGLE 4 DOOR	X	X
FREE STANDING DOUBLE 1 DOOR	✓	✓
FREE STANDING DOUBLE 2 DOOR	✓	✓
FREE STANDING DOUBLE 3 DOOR	OPTION	X
FREE STANDING DOUBLE 4 DOOR	X	X
MODULAR SPLIT DOOR	✓	✓
MODULAR 1 DOOR	✓	✓
MODULAR 2 DOOR	✓	✓
MODULAR 3 DOOR	OPTION	X
MODULAR 4 DOOR	X	X
MEETING & COLLABORATIVE BENCH	OPTION	X

## 2020 STANDARD COLOURS

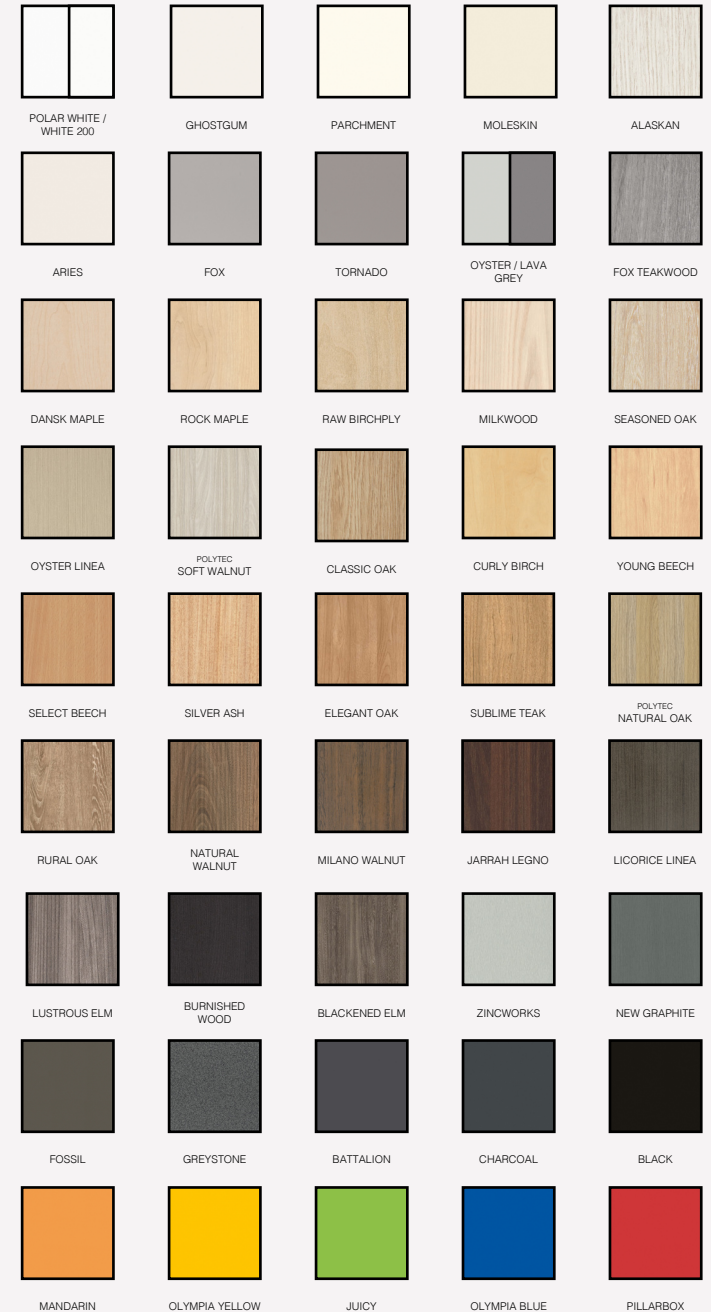



## LOCKERS

*Options & Add-Ons*

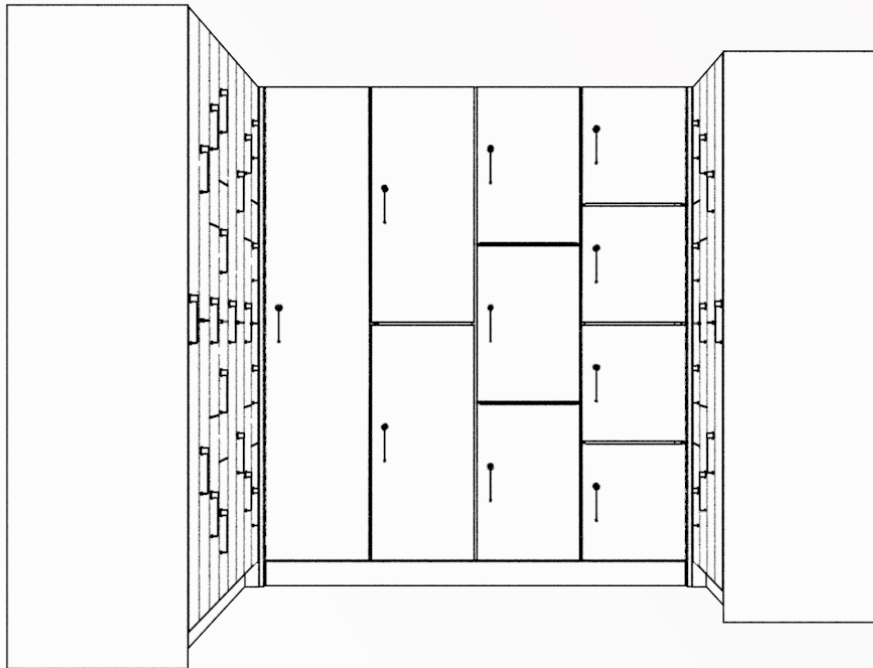

### LOCK HANDLE

*Standard Option*

OVERALL DIMENSIONS

**L:** 144

**W:** 24

**H:** 26

- Zinc alloy, nickel plated
- Master key system options



### CAM LOCK (LOCKABLE WITH PADLOCK)

*Upgrade*

VISIBLE DIMENSIONS  
PROTRUDES: 33

Aperture suits user provided  
padlock up to  $\varnothing 7.5$

#### HANDLE

- Zinc alloy, chrome plated polished
- LOCKING CAM
  - Steel, nickel plated

*other components galvanised*



### DIGITAL LOCK

*Upgrade*

OVERALL DIMENSIONS

**L:** 136

**W:** 33

**D:** 28

- Zinc alloy
- 11 button keypad
- 8 digit Master Code
- 4 digit User Code
- Two year guarantee
- Keyless system
- 15,000 operations from 2 x AAA batteries
- Battery override



ISO 9001 Accredited Quality Management System  
ISO 14001 Accredited Environmental Management System





### LABEL FRAME

*Upgrade*

OVERALL DIMENSIONS

**L:** 85

**W:** 43

- Steel, nickel plated
- Pin mounted

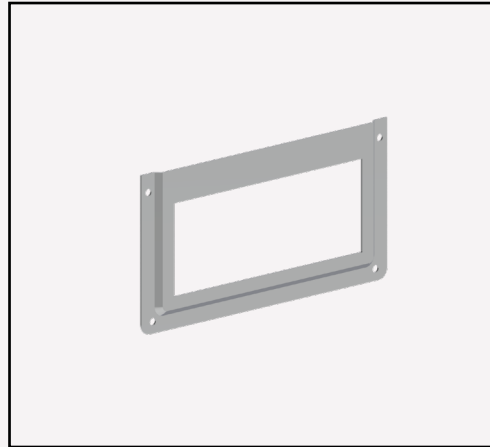

### VENTILATION TRIM

*Upgrade*

OVERALL DIMENSIONS

ø55

- White plastic
- Recess mounting
  - Flanged rim
- Harpoon-type fixing

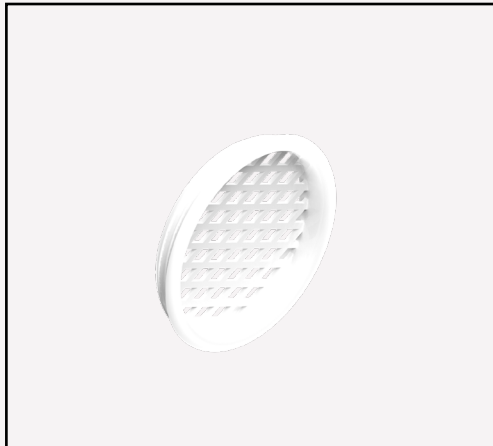

### DUAL CLOTHING HOOK

*Upgrade*

OVERALL DIMENSIONS

**L:** 40

**W:** 49

**D:** 25

- Aluminium, polished
- Screw mounted

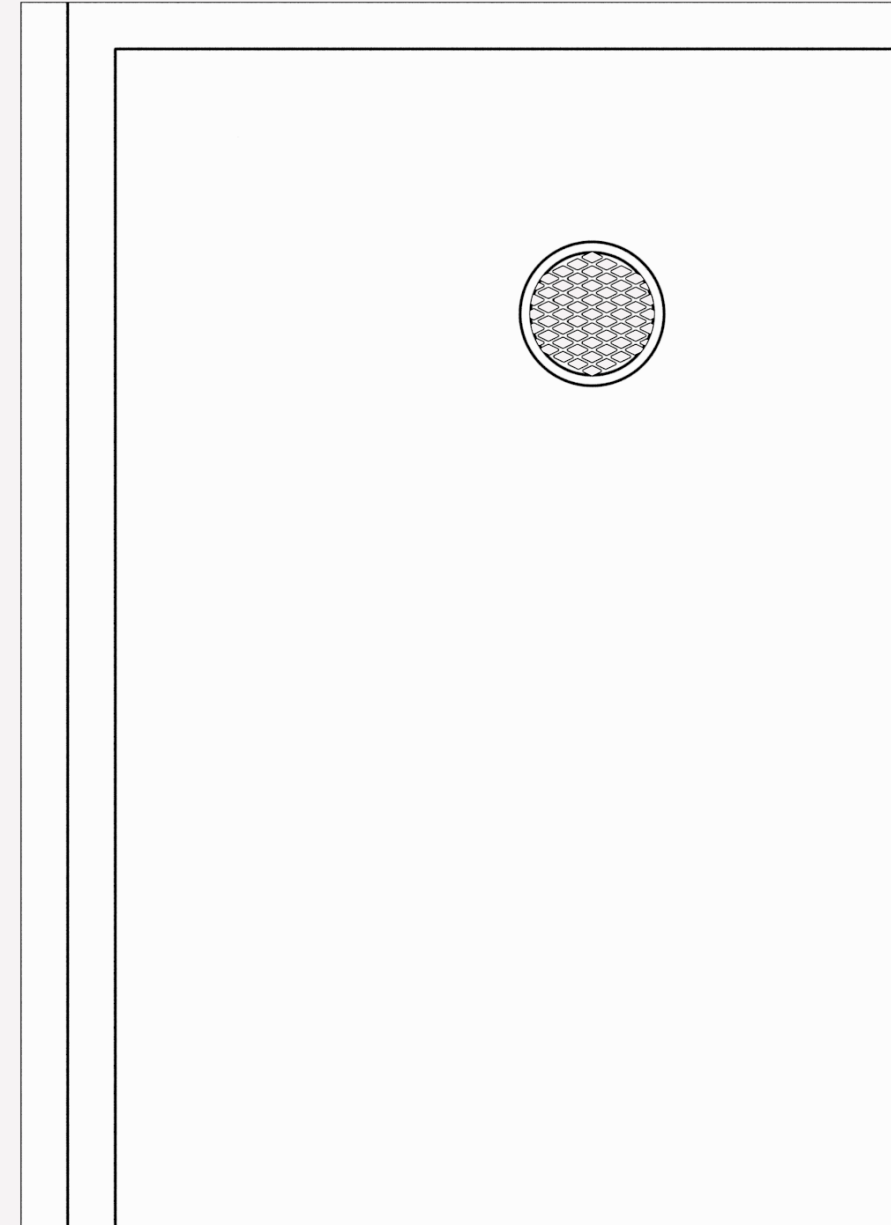



### D-END BADGE

*(Upgrade)*

*DIMENSIONS*

**L: 188**

**W: 40**

Suits 'Lock Handle'  
Engraved 1.6mm plastic  
Up to 3 digits



### BITE BADGE

*(Upgrade)*

*DIMENSIONS*

**L: 36**

**W: 40**

Suits both 'Lock Handle' & 'Cam Lock'  
Engraved 1.6mm plastic  
Up to 3 digits



### BASIC SHAPES BADGE

*(Upgrade)*

*ROUND DIMENSIONS*

ø50

*RECTANGULAR DIMENSIONS*

**L: 90**

**W: 55**

All purpose application  
Engraved 1.6mm plastic  
Up to 3 digits

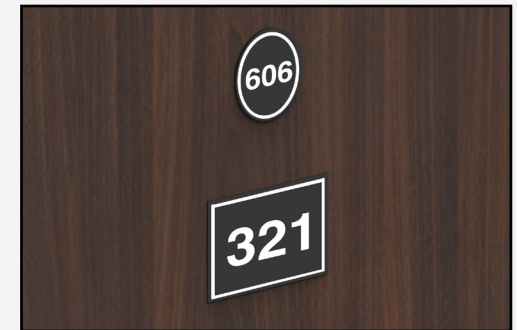

### VINYL LETTERING

*(Upgrade)*

Highly flexible design  
Easily updatable





[mdesk.com.au](http://mdesk.com.au)

Please note that all renders are only indicative of Laminex & Polytec  
Commercial Palettes. Swatch samples should be used for true likeness.  
MDC reserves the right to change specification without notice.